

mychef concept S 4GN 1/1 T



TECHNICAL FEATURES

GN 20 mm capacity	8 x 1/1GN
GN 40 mm capacity	4 x 1/1GN
GN 65 mm capacity	3 x 1/1GN
Distance between GN runners	64 mm
Meals per day	20-80
Maximum temperature	300 °C
Dimensions (Width x Depth x Height)	760x595x662 mm
Weight	76 kg
Packaging dimensions (Width x Depth x Height)	802x765x894 mm
Gross weight	86 kg
Power	5,6 kW
Voltage	230/L+N/50-60 230/3L/50-60 400/3L+N/50-60
Water	R 3/4" x 2
Drain	DN 40
Water pressure	150 - 400 kPa

GENERAL SPECIFICATIONS

LCD control panel

Three fan speeds and reverse flow

99 programs, each with 5 cooking phases

9 short-cut memory settings

Guided semi-automatic cleaning system.

Convection cooking mode from 30°C to 300°C

Steam cooking mode from 30°C to 130°C.

Mixed cooking mode from 30°C to 300°C.

High thermal inertia 1.2 mm-thick hygienic chamber

GN runners

The fan turns off when the door is opened

LED chamber light

Fast cooking. Automatic temperature setting

Magnetic connector for external probe

Folding double-pane, low-emissivity glass door

Built-in drain trap with drainage water cooling

Fluid collection tray on door and frame; includes a drain

Door opening positioner

USB connection

IPX5

OPTIONAL FEATURES

TSC, maximum precision when cooking at low temperatures.

MyCare self-cleaning system

Left-side door opening

ACCESSORIES

First installation Kit

descaler filter

Special trays for each cooking process

Cleaning shower

Condensation hood

Sous-vide magnetic probe (1 point)

Single point magnetic probe (1 point)

Multi-point magnetic probe (4 points)

Cleanduo detergent

MySmoker

Support tables

Wall mount

INSTALLATION INFORMATION

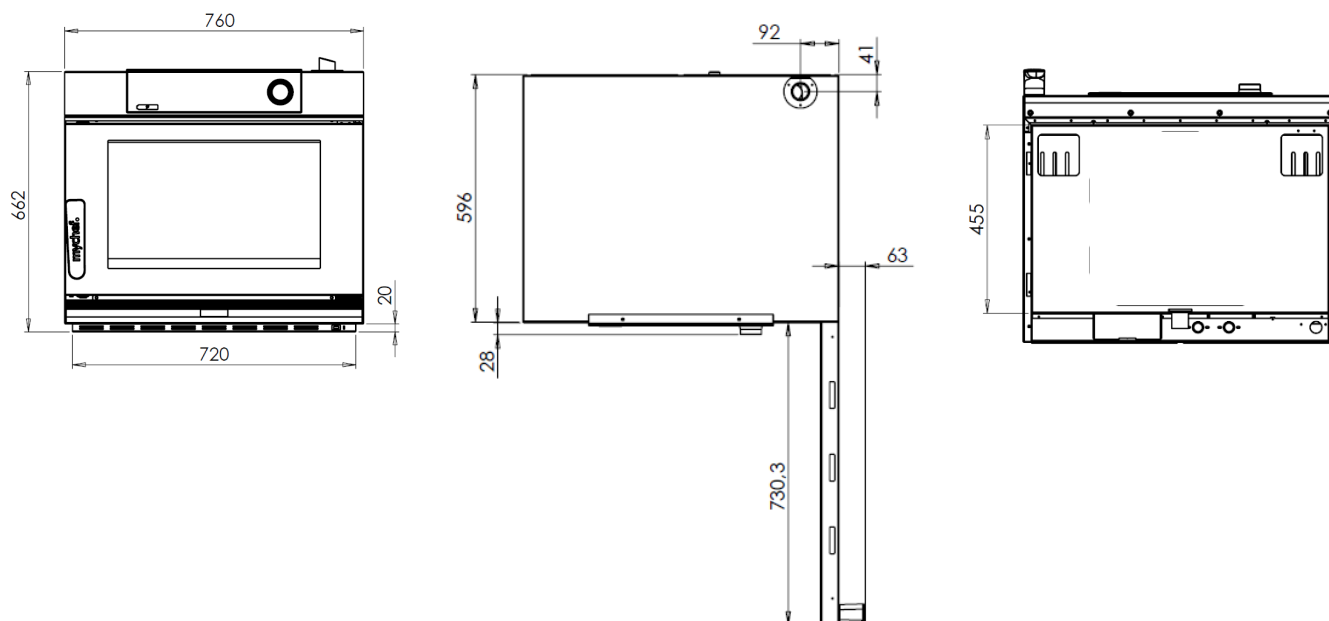

SAFETY DISTANCES

Sides = 50 mm

Rear = 100 mm

Top = 500 mm

Heat sources = 1000 mm

Must be placed absolutely level



ELECTRICAL CONNECTION

	Power (kW)	Current (A)
230/L+N/50-60 ½Power	2,9	13
230/ L+N /50-60	5,6	25
400/3L+N/50-60	5,6	13
230/3L/50-60	5,6	13

WATER CONNECTION

A	¾" connection for treated water
B	¾" connection for untreated water
C	DN 40 drain

WATER QUALITY

Temperature <30°C

150 to 400 kPa flow of dynamic pressure

Hardness between 3° y 6° FH

PH between 6.5 and 8.5

Chlorides below 30 ppm

A descaler and filter must be used

